

custom-designed DC/DC-Converter 0,2 ... 0,5kW

Performance data:

- pulse current limiting
- operation indication
- under-/overvoltage and overtemperature protection
- overload and short-circuit protected
- volt-free alarm contact (SPDT) on undervoltage, overload or overtemperature
- polarity inversion protected
- decoupling diode at output (option)
- fitted in a flanged U-shaped aluminium chassis for easy mounting
- convection cooling

Technical Data

Input voltages	24 / 48 / 60 / 110 / 125 / 220V DC
Input voltage tolerance	+/- 20%
Output voltage	24 ... 250V DC stab. adjustable $\pm 10\%$
Potential separation	2,5kV 50Hz 1min; above 300W 5kV
Over current limiting	$1,1 \cdot I_N$
Stroke frequency	approx. 30kHz
Ripple voltage	approx. 50mV _{PP}
Effectivity	approx. 85%
Operating ambient temperature	-20° ... +60°C without condensation -20° ... +50°C without condensation for GSW 500

Other voltages and time limited overload capacity on demand.

Operation in parallel only with decoupling diode permitted !

Approximate dimensions:

Typ	Nominal power	a	b	w	H	L	Ø	Weight
GSW 200	200W	155	160	170	70	200	5,5	1,2kg
GSW 300	300W	203	200	215	100	260	6	2,1kg
GSW 500	500W	203	200	215	100	260	6	3,1kg

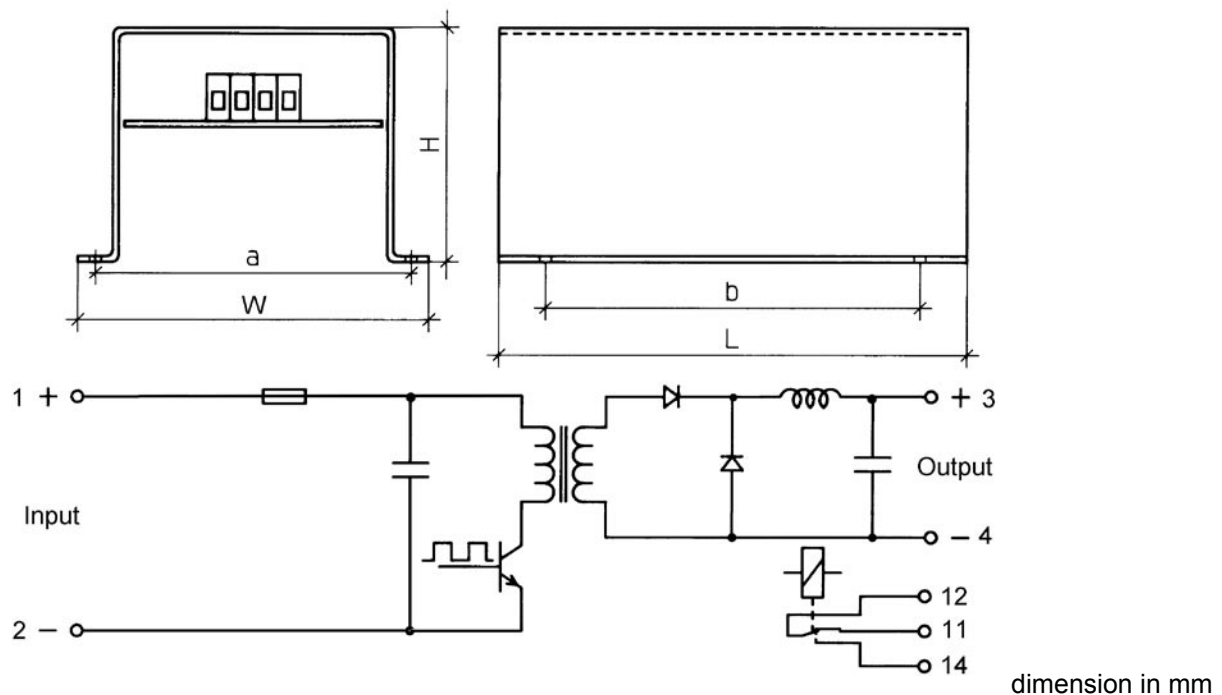

dimension in mm

Subject to technical changes without prior notice



HOTLINE
07191/182-235
-214



INTERNET
www.ees-online.de

EES Elektra Elektronik GmbH & Co Störcontroller KG
Hummelbühl 7-9 • D-71522 Backnang/Germany • P.O.Box 12 40 • D-71502 Backnang
Telephone: +49(0)7191/182-0 • Telefax: +49(0)7191/182-200 • e-mail: info@ees-online.de